



Joint Sub-Registrar
of Alipore

- cents with
- Portion 8
- 1.
- situations
- Portion 8
- 3.
- situations
- Portion 8
- 4.
- cents with
- Portion 8
- 5.
- situations
- Nov. 10, 66
- 6.
- cents with
- Portion 8
- 7.
- cents with
- Portion 8
- 8.
- measuring
- Dist. 24-P
- recorded
- 9.
- measuring
- J.L. 23 DI
- recorded
- 10.
- situations
- Portion 8

17 29

1857

2 Rs.

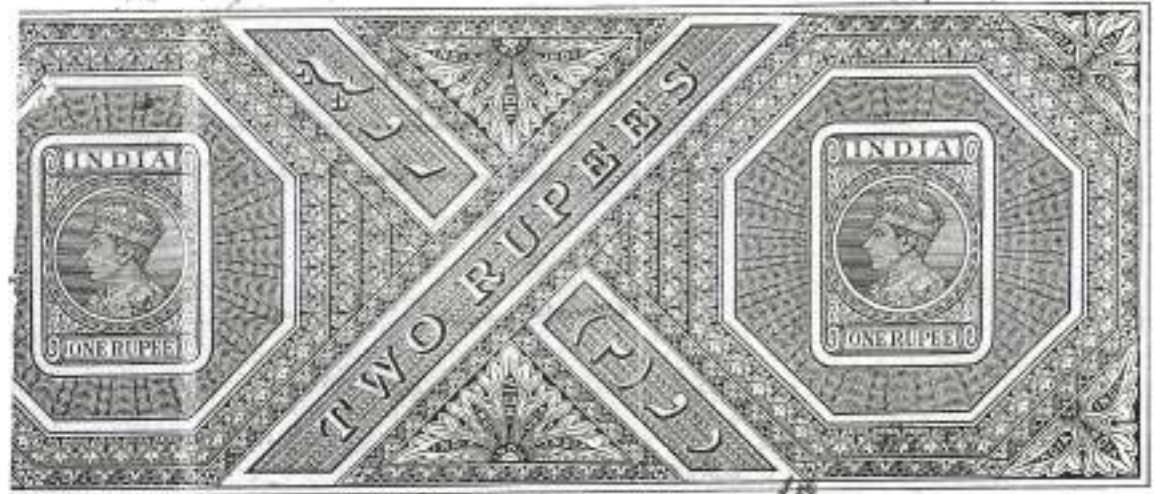

दो रुपया

12 MAR 1860

Fees paid as under 1/34/

under the Law of 1857
 Schedule No. 25 (b)
 in order to have stamp
 in connection with the
 18 No.

Stamp
 this is a duplicate of
 the original

Registering Officer



PARTITION

... 25th ...

... of ...

... by profession ...

... Registrar's office Alipore Dist. ...

... first party ...

... second party ...

... third party ...

... son of ...

... by profession ...

... Registrar's office Alipore



20th 1900: 1
 24-PARGANAS, ALIPORE

COUET OF M...
 FILE
 13 SEP. 1885
 24-PARGANAS

12 MAR. 1885

Dist. - Part was therein stated to be the fifth party. It is stated that
 the said... L. I. Mukherjee did leave five sons namely the
 the second party, 3rd party, 4th party
 First party, and the fifth party. Also the properties of Schedules
 A & B some of which he got by inheritance, some of which by purchase
 and some by purchase in the name of others and the 1st party, and
 party, and party, 4th party and the fifth party inherited these
 properties as heirs of their father and had been in joint
 possession on the roof; that each of the above parties has got one fifth
 share in the said properties; that a third party at present has
 been in the possession of the said properties as if he had become
 tenant of the said five parties to jointly possess and enjoy the
 property of the said parties and the five parties in schedule A. All
 these properties were used as building standing on one of the
 properties was built by the said parties and the said parties had been
 in possession thereof. In the schedule A together with two
 maps in description of the same and a Pucca dwelling house
 standing thereon in the said name and this property schedule A
 is allotted to all the parties according to their shares and each
 party's share is shown in the said map in different colours. The
 portion marked A with the surmount is shown in the said map is allotted
 to 1st party. The portion marked B with the surmount is shown in the
 said map is allotted to 2nd party and the portion marked C with
 the surmount is shown in the said map is allotted to 3rd party and the
 portion marked D with the surmount is shown in the said map is allotted
 to 4th party and the portion marked E with the surmount is shown in the
 said map is allotted to 5th party and each party would get the
 portion allotted to each party's share exclusively save and except.
 The... shown in the said
 map is allotted to all the parties for

2) Jagan
 Mohan
 Nath Me
 Lutsjee

...

...



FILED
FEB 1970
MADRAS HIGH COURT

FILED
15 SEP. 1965
MADRAS HIGH COURT

FILED
MAY 1969
MADRAS HIGH COURT

their own convenience. But also the existing outlets for rain water and the like are to be kept open for all times to come by the parties or their heirs and administrators.

In the schedule B is given the full description of all other divided properties and tenanted acquired by the said P. B. Aritha Lal Babu, deceased through purchase in his own name, in the benefit of others and through inheritance.

Schedule B properties are valued in consultation with all the parties according to the present day Market Valuation and are allotted to the parties according to their shares in schedules C, D, E, F and G.

Schedule C properties are exclusively allotted to the 1st party.

Schedule D properties are exclusively allotted to the 2nd party.

Schedule E properties are exclusively allotted to the 3rd party.

Schedule F properties are exclusively allotted to the 4th party.

Schedule G properties are exclusively allotted to the fifth party.

movable properties left by the said Babu Aritha Lal Babu deceased, had already been divided long ago. It is agreed amongst the parties that each party will absolutely get and exclusively enjoy the properties allotted to his respective share, and the other four parties will cease to have any interest in them. Value of the entire net estate consisting of properties of Schedule A & B is estimated through expert's opinion at Rs.10,000/- (Ten thousand) and the value of the share of each party is estimated at Rs.2,000/-. It is further agreed that the title deeds of the properties in Schedule A will remain with first

FILED
27 FEB 1971
24-PARGANAS, MOOSE

COURT OF MOOSE, ALIPORE
FILED
15 SEP 1968
24-PARGANAS

12 MAR 1969

party in the title deeds of properties mentioned in Schedule C will remain with 1st party, the title deeds of properties mentioned in Schedule D will remain with 2nd party, the title deeds of properties mentioned in schedule E will remain with 3rd party and that of properties mentioned in schedules F & G will remain with fourth & fifth parties respectively. The 1st & 2nd parties will procure documents for the 3rd of the other party or parties whenever required and each party will get his name recorded separately in the Zaminar's sherists of Judicial Office in respect of his separate properties and will pay the property tax in respect of his separate properties from his own pocket without any concern of the other four parties. Each of the five parties has got separate possession of the allotted properties allotted separately to them from this day and each party has got no interest left in the properties allotted to the other four parties.

SCHEDULE A.

All that piece and parcel of land situated at the Mouza Paschim Barisha, P.S. Behala Sub-Registry Alipore Dist. 24-Parganas pertaining to C.S. Khatia Nos. 124 and 728 and 2168 measuring .45 cents C.S. Plots Nos. 469, 235 and 469/813 J.L. 19 Touzie 1-4, 5, 6, 8-10, 12-16 and 435 of the Alipore Collectorate. The plan of the parties are shown in the plan annexed herewith and marked A, B, C, D, E respectively.

All that piece and parcel of land situated at the Mouza Paschim Barisha, P.S. Behala Sub-Registry Alipore Dist. 24-Parganas pertaining to C.S. Khatia 1998 measuring .52 cents C.S. plots Nos. 471 and 472 J.L. 19 Touzie 1-6, 8-10, 12-16 shares of the parties are shown in the plan annexed herewith and marked B, C, D, E respectively.

SCHEDULE B.

1. All that piece and parcel of land measuring .38



12 MAR. 1969

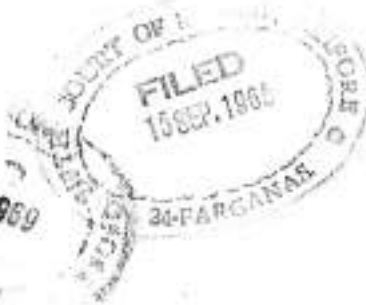

- cents situate at the Mouza Paschia Barisha P.S.Bahal J.L.19 Dist.24-Parganas Khatian Nos.124 and 788 Plot Nos.467 and 470.
2. All that piece and parcel of garden land measuring .10 cents situate at the Mouza Paschia Barisha P.S.Bahal J.L.19 Dist.24-Parganas Khatian Nos.9, 65 and 126 Plot Nos.458.
3. All that piece and parcel of garden land measuring .35 cents situate at the Mouza Paschia Barisha P.S.Bahal J.L.19 Dist.24-Parganas Khatian No.1251 Plot Nos.3084, 3081.
4. All that piece and parcel of garden and tank measuring .91 cents situate at the Mouza Paschia Barisha P.S.Bahal J.L.19 Dist.24-Parganas Khatian No.1459 Plot Nos.3084, 3080 and 3085.
5. All that piece and parcel of garden land measuring .61 cents situate at the Mouza Paschia Barisha P.S.Bahal J.L.19 Dist.24-Parganas Khatian Nos.10,06 and 127 Plot No.3084.
6. All that piece and parcel of garden and tank measuring .56 cents situate at the Mouza Paschia Barisha P.S.Bahal J.L.19 Dist.24-Parganas Khatian No.787/1 Plot Nos.3277 and 3278.
7. All that piece and parcel of garden and tank measuring .82 cents situate at the Mouza Paschia Barisha P.S.Bahal J.L.19 Dist.24-Parganas Khatian No.350 Plot Nos.3279 and 3280.
8. All that piece and parcel of garden, Patta, Tank and Doba measuring .70 cents situate at the Mouza Paschia Barisha P.S.Bahal J.L.19 Dist.24-Parganas Khatian No.1125 Plot Nos.3675, 3676, 3677 and 3676/3934 recorded in Sub Khatian No.1126.
9. All that piece and parcel of Patta, Doba and low land measuring .61 cents situate at the Mouza Paschia Barisha P.S.Bahal J.L.19 Dist.24-Parganas Khatian No.335 Plots Nos.2079, 2080 and 2083 recorded in Sub Khatian 336.
10. All that piece and parcel of garden land measuring .12 cents situate at the Mouza Paschia Barisha P.S.Bahal J.L.19 Dist.24-Parganas Khatian No.273 Plot No.3275.



- 11. All that piece and parcel of paddy land measuring .19 cents situate at the Mouza Paschia Barisha P.S. Bahala Dist. 24-Parganas J.L. 19 Khattin Nos. 175 and 876 Plot No. 2078.
- 12. All that piece and parcel of Garden land measuring 1.93 Acre situate at the Mouza Paschia Barisha P.S. Bahala Dist. 24-Parganas J.L. 19 Khattin Nos. 15, 71 and 162 Plot No. 3274, 3275 and 3276.
- 13. All that piece and parcel of Garden land measuring .17 cents situate at the Mouza Paschia Barisha P.S. Bahala Dist. 24-Parganas J.L. 19 Khattin No. 212 Plot No. 453.

BRICK PADDY LANDS.

- 14. All that piece and parcel of paddy land measuring 1.49 Acre situate at the Mouza Paschia Barisha P.S. Bahala Dist. 24-Parganas J.L. 19 Khattin No. 1313 Plot No. 1830.
- 15. All that piece and parcel of paddy land measuring .49 cents situate at the Mouza Paschia Barisha P.S. Bahala Dist. 24-Parganas J.L. 19 Khattin No. 1356 Plot No. 1366.
- 16. All that piece and parcel of paddy land measuring 1.15 Acre situate at the Mouza Paschia Barisha P.S. Bahala Dist. 24-Parganas Khattin No. 723 Plot Nos. 1690 and 1696.
- 17. All that piece and parcel of paddy land measuring .50 cents situate at the Mouza Paschia Barisha P.S. Bahala Dist. 24-Parganas Khattin No. 87 Plot Nos. 1647 and 1649.
- 18. All that piece and parcel of paddy land measuring .12 cents situate at the Mouza Paschia Barisha P.S. Bahala Dist. 24-Parganas Khattin No. 334 Plot No. 1118.
- 19. All that piece and parcel of paddy land measuring 2.39 Acre situate at the Mouza Paschia Barisha P.S. Bahala Dist. 24-Parganas Khattin Nos. 597 and 1646 Plot Nos. 1603, 1604, 1739, 1823, 1898, 1997 and 1159.
- 20. All that piece and parcel of paddy land measuring 1.14 Acre situate at the Mouza Paschia Barisha P.S. Bahala Dist. 24-Parganas

P. Subudh. N. 22



Khatian Nos.453 and 1102 Plot Nos.1602, 1636 and 1645 and 1330.

21. All that piece and parcel of paddy land measuring .23 cents situate at the Mouza Paschim Barisha P.S.Behala Dist.24-Parganas Khatian No.2134 Plot No.3072.

22. All that piece and parcel of paddy land measuring .60 cents situate at the Mouza Paschim Barisha P.S.Behala Dist.24-Parganas Khatian No.1541/1 and Plot Nos.1333 and 3088.

23. All that piece and parcel of paddy land measuring .23 cents situate at the Mouza Paschim Barisha P.S.Behala Dist.24-Parganas Khatian No.1175 and Plot No.1690,2320.

TEKANTED LANDS.

24. All that piece and parcel of paddy land measuring .57 cents situate at the Mouza Paschim Barisha P.S.Behala Dist.24-Parganas Khatian No.1108 Plot No.1029, 2213.

25. All that piece and parcel of paddy land measuring .50 cents situate at the Mouza Kalagatchia P.S.Mohestollah Dist.24-Parganas Khatian Nos.39, 79 and 129 Sub Khatian 255 Plot Nos.335 and 336.

26. All that piece and parcel of paddy land measuring .42 cents situate at the Mouza Paschim Barisha P.S.Behala Dist.24-Parganas Khatian No.1105 Plot No.2619.

27. All that piece and parcel of paddy land measuring 3.73 Acre situate at the Mouza Paschim Barisha P.S.Behala Dist.24-Parganas Khatian No.1103 Plot Nos.1795 and 1796 2227.

28. All that piece and parcel of paddy land measuring 2.28 Acre situate at the Mouza Paschim Barisha P.S.Behala Dist.24-Parganas Khatian No.1104 Plot No.1803.

29. All that piece and parcel of paddy land measuring 1.07 Acre situate at the Mouza Paschim Barisha P.S.Behala Dist.24-Parganas Khatian No.742 Plot No.2126.

30. All that piece and parcel of paddy land measuring .77 cents situate at the Mouza Paschim Barisha P.S.Behala Dist.24-Parganas



Khatian No. 1004 and 741 Plot Nos. 1129 and 1114.

31. All that piece and parcel of B. sta. land measuring .42 cents situate at the Mouza Paschim Barisha P.S. Bahala Dist. 24-Parganas Khatian No. 131 Sub Khatian 137 Plot No. 3481.

32. All that piece and parcel of B. sta., Daba, Dama Tank etc., measuring 1.41 acre situate at the Mouza Paschim Barisha P.S. Bahala Dist. 24-Parganas Khatian No. 1230 Sub Khatians 1231 & 1232. Plot Nos. 3108, 3109, 3110, 3111, 3112, 3493 and 3494.

33. All that piece and parcel of B. sta. land measuring 0.4 cents situate at the Mouza Paschim Barisha P.S. Bahala Dist. 24-Parganas Khatian No. 1002 Sub Khatian 1003. Plot No. 1200.

34. All that 1/2 share in the piece and parcel of B. sta. land measuring .74 cents situate at the Mouza Paschim Barisha P.S. Bahala Dist. 24-Parganas Khatian No. 498 and 1381 Sub Khatian No. 1384 Plot No. 3025.

35. All that piece and parcel of sandy land measuring 1.19 acre situate at the Mouza Paschim Barisha P.S. Bahala Dist. 24-Parganas Khatian No. 1647 Plot No. 2110.

36. All that piece and parcel of Daba and Dama measuring .68 cents situate at the Mouza Paschim Barisha P.S. Bahala Dist. 24-Parganas Khatian No. 1648 Plot No. 3176, 3177.

37. All that piece and parcel of B. sta. land measuring .36 cents situate at the Mouza Paschim Barisha P.S. Bahala Dist. 24-Parganas Khatian No. 1349 Plot No. 1606.

38. All that piece and parcel of B. sta. land measuring .14 cents situate at the Mouza Paschim Barisha P.S. Bahala Dist. 24-Parganas Khatian No. 18 Plot No. 1120.

39. All that piece and parcel of Garden land measuring .12 cents situate at the Mouza Paschim Barisha P.S. Bahala Dist. 24-Parganas Khatian No. 100 Sub Khatian 1003 Plot No. 1196.



40. All that piece and parcel of Bastu land measuring .73 cents situate at the Mouza Paschim Barisha P.S.Behala Dist.24-Parganas Khatian No.1341/2 Plot No.1350.
41. All that piece and parcel of Bastu and Doha measuring .30 cent situate at the Mouza Purba Barisha P.S.Behala Dist.24-Parganas Khatian No.333 Sub Khatian No.334 Plot Nos.2073 and 2074.
42. All that piece and parcel of paddy land measuring .93 cents situate at the Mouza Purba Barisha P.S.Behala Dist.24-Parganas Khatian No.416 Sub Khatian No.417 Plot No.3119.
43. All that piece and parcel of paddy land measuring 1.49 Acre situate at the Mouza Purba Barisha P.S.Behala Dist.24-Parganas Khatian No.412 Sub Khatian No.433 Plot No.3013.

C SCHMIDT'S PROPERTY OF 1ST PARTY.

1. The A marked portion of the property mentioned in the A Schedule of is demised with two Pucca rooms upstairs and downstairs, two covered Verandah upstairs and downstairs, one covered Verandah in front of the room with roof, one privy and the back portion Bank with walls and open space running upto the Bank opposite to the covered Dalan of the fifth party and open land on the south of the common passage and on the plot of the bank allotted to Fifth party as shown in the plans annexed herewith.
2. All that piece and parcel of paddy land situate at the Mouza Paschim Barisha P.S.Behala Dist.24-Parganas measuring 1.34 Acre appertaining to C.S.Khatian Nos.453 and 1102 and C.S.Plot Nos.1602, 1636, 1645 and 1130 (has and in under Khatian Nos.1103, 1104, 1105 and 1108 paddy lands measuring 6.97 acres tenanted. Annual Rental of Rs.14/6/5 is payable to the Touzie holders 1-6, 8-10, 12-16.
3. All that piece and parcel of tenanted Bastu and Doha land measuring .30 cent situate at the Mouza Purba Barisha P.S.Behala Dist.24-Parganas appertaining to C.S. Khatian No.333 under Khatians 334 and Plot Nos.2073 and 2074. Annual rental of Rs.1/0/8 plus is payable to the Touzie holders 1-6, 8-10, 12-16.



4. All that piece and parcel of Pott free paddy land measuring .32 cent situate at the Mouza Paschim Barisha P.S. Behala Dist. 24-Parganas appertaining to C.S. Khatian Nos. 557 and 1646 and C.S. Plot No. 1603
5. All that piece and parcel of Banga land and tank measuring .66 cents situate at the Mouza Paschim Barisha P.S. Behala Dist. 24-Parganas appertaining to C.S. Khatian No. 787/1 and Plot Nos. 3277 and 3278. Annual Rental of Rs. 5/10/- is payable to Touzie holders Nos. 1-4, 5, 6-8, 10, 12-16. A passage 8 ft. wide running from the Municipal road right upto this land and Plot No. 3279 allotted to fifth party over C.S. Plot No. 3274 on the eastern boundary line of the same is kept common by the parties. This passage may be used by the parties in taking electric lines and for all other right of easements.
6. All that piece and parcel of Banga land measuring .20 cents situate at the Mouza Paschim Barisha P.S. Behala Dist. 24-Parganas appertaining to C.S. Khatian Nos. 9, 65 and 196 and Plot No. 458. Annual Rental of Rs. 1/14/6 is payable to Touzie holders Nos. 3, 4 and 5. The right of way to this land will have along the west north and eastern bank of the tank allotted to fifth party.
7. All that piece and parcel of Banga land measuring .17 cents situate at the Mouza Paschim Barisha P.S. Behala Dist. 24-Parganas appertaining to C.S. Khatian No. 212 and Plot No. 453. Annual rental of Rs. 1/3/3 is payable to the estate of Durgacharan Mukerjee & others.
8. All that piece and parcel of partly rentfree and partly rented Khas Banga land measuring .19 cents situate at the Mouza Furba Barisha P.S. Behala Dist. 24-Parganas appertaining to C.S. Khatian No. 875 and 876 and Plot No. 2078.

B SCHEDULE PROPERTY ALLOTTED TO FIFTH PARTY.

1. The B marked portion of the property mentioned in the Schedule A of this deed with two pucca rooms upstairs and downstairs, two pucca Dalans upstairs and downstairs, one covered Verandah in front of the Dalan with roof, stairs leading upto the second floor.



- free and bare portion rank with wall and one privy and two open lands marked B, shown in the plans annexed herewith.
2. All that piece and parcel of Kh's paddy land situate at the Mouza Paschim Barisha P.S. Behala Dist. 24-Parganas appertaining to C.S. Khatian No. 1175 and Plot No. 1690/2320 measuring .23 cents and all that piece and parcel of tenanted paddy land situate at the Mouza Purba Barisha P.S. Behala Dist. 24-Parganas appertaining to C.S. Khatian No. 416 under Khatian No. 417 Plot No. 3119 measuring .93 cents. Annual Rental of Rs. 6/5/6 pie is payable to the estate of Chandra Sekhar Das Naskar and Jotindra Nath Das Naskar of Sarsopah.
 3. All that piece and parcel of paddy land measuring .60 cents situate at the Mouza Paschim Barisha P.S. Behala Dist. 24-Parganas appertaining to C.S. Khatian No. 1541/1 and Plot No. 1333 and 3088 and tenanted Danga land measuring .23 cents situate at the same Mouza appertaining to C.S. Khatian No. 1541/2 and Plot No. 1350. Annual rental of Rs. 6/12/0 is payable to the estate of Babindra Nath Roychowdhury and others of Barisha, Kumar Bahadur Kumar Mukherjee and others.
 4. All that piece and parcel of Kh's rent free paddy land measuring .7 cents situate at the Mouza Paschim Barisha P.S. Behala Dist. 24-Parganas appertaining to C.S. Khatian Nos. 557 and 1646 and Plot No. 1642.
 5. All that piece and parcel of tenanted Bantu land measuring .42 cents situate at the Mouza Paschim Barisha P.S. Behala Dist. 24-Parganas appertaining to C.S. Khatian No. 131 and Sub Khatian 132 Plot No. 3281. Annual rental of Rs. 0/8/- is payable to Kh's Behal Deptt.
 6. All that 1/2 share in the piece and parcel of Bantu land measuring .84 cents situate at the Mouza Paschim Barisha P.S. Behala Dist. 24-Parganas appertaining to C.S. Khatian Nos. 498 and 1383 and Plot No. 3025. Recorded as liable to rent.
 7. All that piece and parcel of Danga land measuring .04 cents and paddy land measuring .15 cents situate at the Mouza Paschim Barisha



- 1002
 P.S.Behala Dist.24-Parganas appertaining to G.S.Khatian Nos. 1003 and 1004 Plot Nos.1200 and 1329. Annual rent 1 of Rs. /- is payable to the estate of Durga Charan Mukerjee & others.
8. All that piece and parcel of tenanted Danga land measuring .12 cents situate at the Mouza Paschim Barisha P.S.Behala Dist.24-Parganas appertaining to G.S.Khatian No.2307 and under Khatian No.2303 Plot No.3146. Annual rent 1 of Rs.14/8 pie is payable to the estate of Sarat Chandra Datta Chowdhury and others.
9. All that piece and parcel of 1/3rd share in Garden and Tank measuring 1-93 Acre situate at the Mouza Paschim Barisha P.S.Behala Dist.24-Parganas appertaining to G.S.Khatian Nos.15, 71, 162 and Plot Nos.3274, 3275 and 3276. Annual rent 1 of Rs.15/4/- is payable to Touzie holders Nos.3, 4 and 5.
10. All that piece and parcel of Khia Garden, B. stia and Tank measuring .70 cents situate at the Mouza Paschim Barisha P.S.Behala Dist.24-Parganas appertaining to G.S.Khatian No.1125 Sub Khatian 1126 and Plot No. 3675, 3676 3677 and 3676/3934. Annual rent 1 of Rs.5/5/- is payable to the estate of Ek.Jasser Ali and others.

2. SCHEDULE PROPERTY ALLOTTED TO 3RD PARTY.

1. The C marked portion of the property mentioned in the Schedule A of this deed with 4 pieces rooms in the upstairs and downstairs and the balconies upstairs and downstairs, stairs and the back portion extending upto the wall and door on passage, and open land marked C in the part of the building and another plot marked C shown in the plans annexed herewith.
2. All that piece and parcel of Khia paddy lands measuring 1.15 Acre situate at the Mouza Paschim Barisha P.S.Behala Dist.24-Parganas appertaining to G.S.Khatian No.740 Plot No.1690 and 1696 and tenanted paddy lands measuring 1.07 Acre situate at the same Mouza appertaining to G.S.Khatian Nos.741 and 742 Plot Nos.1114 and 1128. Annual rent 1 of Rs.12/- is payable to the estate of Kumer Sanat Kumer



Mukerjee.

3. All that piece and parcel of land containing .40 cents situate at the Mouza Paschia Barish P.S. Bah 1. Dist. 24-Paraganas appertaining to G. Khattin Nos. 557 and 1646 and Plot No. 1893.
4. All that piece and parcel of land fronting on Deba and Danna measuring .68 cents appertaining to G. Khattin Nos. 557 and 1646 and Sub Khattin No. 1648 and Plot No. 3126 and 3127 at Paschia Barish P.S. Bah 1. 24-Paraganas.
5. All that piece and parcel of tenanted Pustu, Gola, Janna, Tamra etc., measuring 1.41 acre situate at the Mouza Paschia Barish P.S. Bah 1. Dist. 24-Paraganas appertaining to G. Khattin No. 1230 and Sub Khattin Nos. 1231 and 1122 and Plot Nos. 3108, 3109, 3110, 3111, 3112 and 3493 and 3494. Annual rent of Rs. 17/3/- is payable to the estate of Jaynarain Chandra and others.
6. All that piece and parcel of 1/3rd share in Kola land and Tank measuring 1.93 acre situate at the Mouza Paschia Barish P.S. Bah 1. Dist. 24-Paraganas appertaining to G. Khattin Nos. 14, 71 and 162 and Plot Nos. 1274, 1275 and 1276. Annual rent of Rs. 13/14/- is payable to Touzie holders Nos. 3, 4 and 5.
7. All that piece and parcel of land measuring .61 cents situate at the Mouza Paschia Barish P.S. Bah 1. Dist. 24-Paraganas appertaining to G. Khattin Nos. 10, 66 and 127 and Plot No. 3084 and tenanted by the last mentioned .14 cents situate at the Mouza Paschia appertaining to G. Khattin No. 108 and Plot No. 1120. Annual rent of Rs. 3/- is payable to Touzie holders Nos. 3, 4 and 5.

UNDIVIDED PROPERTY ALLOTTED TO AIR PARTY.

1. The 5th and 6th portion of the property mentioned in Schedule A of this deed with two rooms and one balcony on the ground floor and open land on the west of the building and another piece of open land containing 2 shares in the place annexed herewith.



2. All that piece and parcel of Kh. a paddy land measuring .90 cents situate at the Mouza Paschim Barisha P.S. Behala Dist. 24-Parganas appertaining to C.S. Khattian No. 672 and Plot Nos. 1647 and 1649. Annual rent of Rs. 5/- is payable to Babu Chandri Charan Ganguly of Barisha.
3. All that piece and parcel of Kh. a paddy land measuring .49 cents situate at the Mouza Paschim Barisha P.S. Behala Dist. 24-Parganas appertaining to C.S. Khattian No. 1366 and Plot No. 1365. Annual rent of Rs. 2/2/- is payable to the estate of Babu Parbati Nath Panigrahy and others.
4. All that piece and parcel of Kh. a paddy land measuring .80 cents situate at the Mouza Paschim Barisha P.S. Behala Dist. 24-Parganas appertaining to C.S. Khattian No. 184 Plot No. 3072. Annual rent of Rs. 1/8/- is payable to the estate of Jagannath Chandra and others.
5. All that piece and parcel of Kh. a paddy land measuring .42 cents situate at the Mouza Paschim Barisha P.S. Behala Dist. 24-Parganas appertaining to C.S. Khattian Nos. 557 and 1646 and Plot No. 1739.
6. All that piece and parcel of Kh. a and partly tenanted Bastu, Doba and low land measuring .81 cents situate at the Mouza Purba Barisha P.S. Behala Dist. 24-Parganas appertaining to C.S. Khattian No. 335 and Sub Khattian No. 336 and Plot Nos. 2079, 2080 and 2083. Recorded as liable to rent.
7. All that piece and parcel of tenanted paddy land measuring 1.49 cents situate at the Mouza Purba Barisha P.S. Behala Dist. 24-Parganas appertaining to C.S. Khattian Nos. 252 and Sub Khattian 253 and Plot No. 3015 Annual rent of Rs. 12/4/3 pies is payable to the estate of Jagannath Chandra and others.
8. All that piece and parcel of rent free tenanted Bastu land measuring .36 cents situate at the Mouza Paschim Barisha P.S. Behala Dist. 24-Parganas appertaining to C.S. Khattian Nos. 557 and 1646 and Sub Khattian No. 109 and Plot No. 1606.

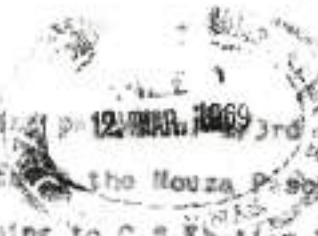

9. All that piece and parcel of Kh's land and tank measuring 1.93 Acre situate at the Mouza Paschim Barisha P.S. Bahala Dist. 24-Parganas appertaining to C.S. Khatian Nos. 71, 15 and 162 and Plot Nos. 374, 3275 and 3276.

SCHEDULE G ALIENING TO FIFTH PARTY.

1. The E marked portion of the property mentioned in the Schedule C of this deed with one pucca room and one covered Verandah in front ~~xxxx xxx xxxxxxxxx~~ of the room with one paddy Gola and walls and the portion of open land in front of the building extending upto the common passage on the south and east and on the west upto Municipal road and another plot of open land as shown in the plans annexed herewith.
2. All that piece and parcel of Kh's paddy land measuring 1.49 cents situate at the Mouza Paschim Barisha P.S. Bahala Dist. 24-Parganas appertaining to C.S. Khatian No. 1313 and Plot No. 1930. Annual rental of Rs. 4/8/- is payable to the estate of Babu Prasad Das Roychowdhuri of Barisha.
3. All that piece and parcel of Rent free Kh's paddy lands measuring .1 cents situate at the Mouza Paschim Barisha P.S. Bahala Dist. 24-Parganas appertaining to C.S. Khatian Nos. 557 and 1646, Plot Nos. 1397/2247, 1159, 1823 and tenanted rent free paddy land at the same Mouza appertaining to C.S. Khatian 1647 Plot No. 2110 measuring 1.19 Acre.
4. All that piece and parcel of land and tank measuring .91 cents situate at the Mouza Paschim Barisha P.S. Bahala Dist. 24-Parganas appertaining to C.S. Khatian No. 1453 and Plot Nos. 3084/3830 and 3085. A common passage 8 ft. wide running from the south eastern corner of Plot No. 3084 extending towards the north and turning towards the east will touch Plot No. 3831 over C.S. Plot No. 3084/3830. Annual rental of Rs. 2/2/3 is payable to the estate of Jurgacharan Mukherjee and others.
5. All that piece and parcel of Kh's Garden land and Dohs measuring .8 cents situate at the Mouza Paschim Barisha P.S. Bahala Dist. 24-Parganas appertaining to C.S. Khatian No. 2350 and Plot No. 3179 and 3080. Annual rental of Rs. 5/13/6 is payable to the estate of Jaynarain Choudhary and others.



6. All that piece and parcel of Kh. Garden land measuring .35 cents situate at the Mouza Paschia Barisha P.S. Behala Dist. 24-Parganas appertaining to C.S. Khatian No. 1981 and Plot No. 3064/3831. Annual rent of Rs. 2/2/3 pias is payable to the estate of Parbatinath Banerjee & ors.

7. All that piece and parcel of Kh. a. Danga lands measuring .12 cents situate at the Mouza Purba Barisha P.S. Behala Dist. 24-Parganas appertaining to C.S. Khatian No. 473 and Plot No. 2075. Annual rental of Rs. 1/1/3 is payable to the estate of Jaynarain Chandra and others.

8. All that piece and parcel of 4/5 share in the tank and land measuring .38 cents situate at the Mouza Paschia Barisha P.S. Behala Dist. 24-Parganas appertaining to C.S. Khatian No. 124 and 788 and Plot No. 467 and 470. Passage to Plot No. 467 will have along the ^{water} ~~containing~~ bank of the tank ^{abutting} Plot No. 458. All the parties will have the right of easements in the aforesaid tank.

9. All that piece and parcel of Kh. paddy land measuring .12 cents situate at the Mouza Paschia Barisha P.S. Behala Dist. 24-Parganas appertaining to C.S. Khatian No. 2304 and Plot No. 3118. Annual rental of Rs. 0/5/4 is payable to the estate of Rajat Chandra Das Chowdhury and others.



Typed by :-
S.C. Mukerjee. 24.8.44.

Witnesses :-

Atish Chandra Banerjee
Barisha

Lakshmi Mukherjee
Barisha

Profulla Kumar Mukerjee
Barisha

Govind Kumar Banerjee
Barisha

Sudhin Chandra Mukerjee

Atindra Nath Mukerjee
Nandini Mukerjee

Bijendra Nath Mukerjee

Sudranata Mukerjee

SEPARATION PLAN
AT DAG NO 471 OF BARISA
SCALE 20 FT = 1 IN.

N.B			
PLOT	NO.	DATE	SHOWN THUS
DO	C	5-2-33	DO DO
DO	B	3-0-6	DO DO
DO	E	7-3-32	DO DO
COMMON PASSAGE			DO DO

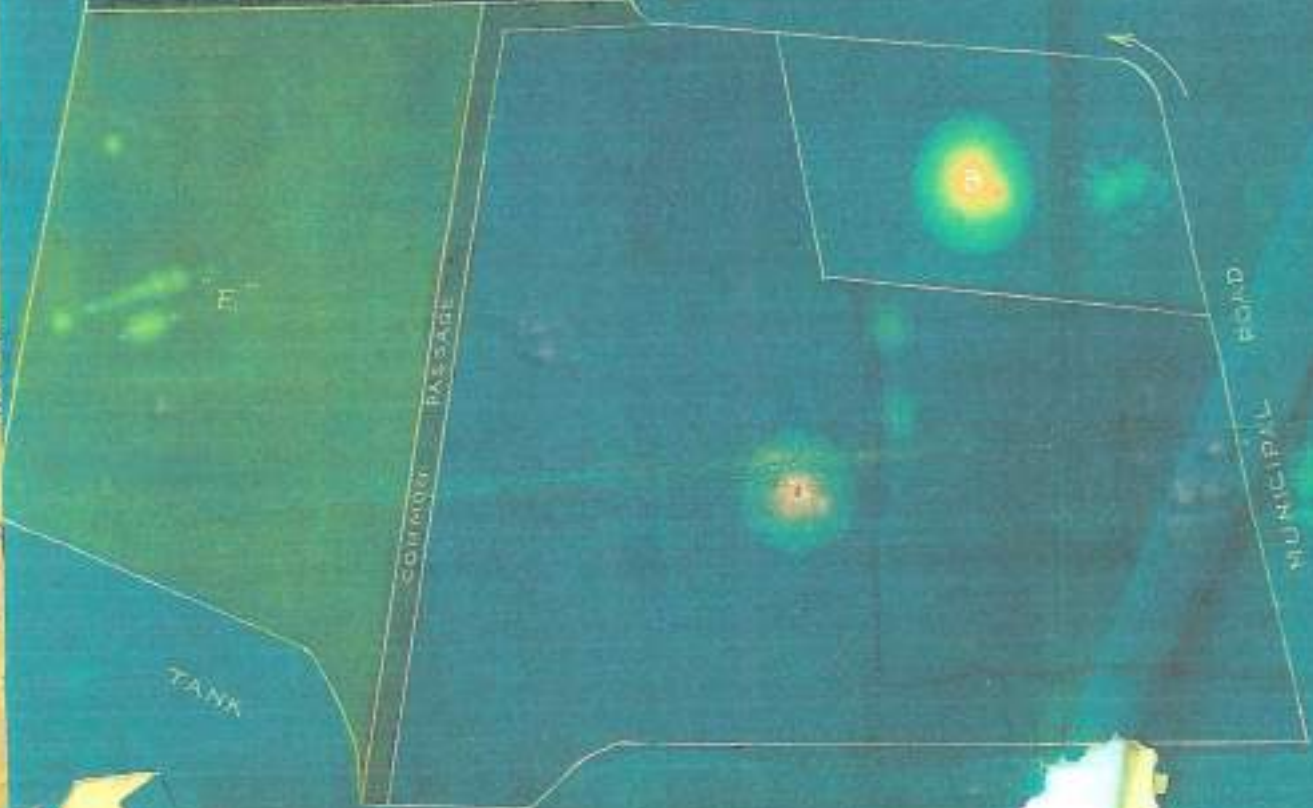

PLOT NO. 471
 Volume No. 11

Book No. 1
 Volume No. 34
 Pages to 260
 Being No. 1857
 for the Year 1944



Sadar
 Sadar Joint Sub-Registrar
 of Alipore.
 2/9/44

12.3
 40885
 58204
 of Alipore
 Joint Sub-Registrar

31.1.46
 MINE
 Exhibit No. 2
 No. 15.9.65
 Filed by 211
 Suit No. 321/65 of 16
 Joint Sub-Registrar & Court
 Alipore

12.3
 40885
 58204
 of Alipore
 Joint Sub-Registrar



1856-34